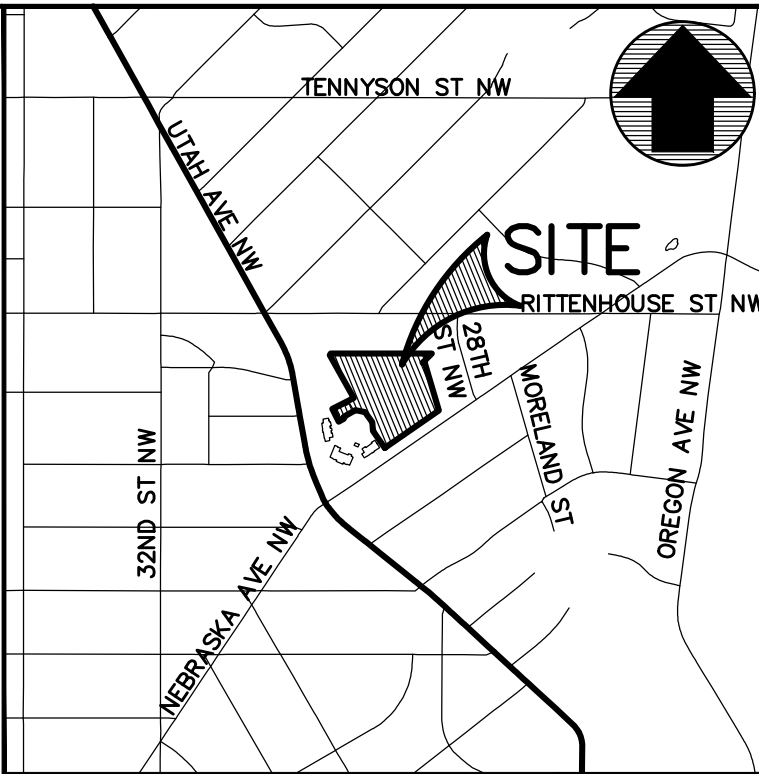

EXHIBIT A



Tree Protection Action Key (TPAK)

TREE PROTECTION CHECKLIST									
DATE	JOB	CONTRACTOR	NOTES	OK'd					
	Pre-construction meeting								
	Install tree protection fencing*								
	Root pruning*								
	Mulch application								
	Special demolition* (Tree 323)								
	SSAT excavation*								

Tree #	DBH	Common Name	Botanical Name	Condition Rating	%	Condition Rating	REGULATED STATUS	SRZ	CRZ	Preservation Measures												Preservation Notes	Assessment Notes
								Structural Critical Root Zone (radius) in Feet	Critical Root Zone Radius in Ft. (1:1)	Root Prune	Mulch	Year 1 Soil Care	Year 2 Soil Care	Special Demolition	Vertical Mulching	Tree Condition Inspections	Watering	Temp Root Protection Matting	Construction Oversight/Monitoring				
323	35	pine, eastern white	Pinus strobus	80%	Good	HERITAGE	18	53	X	X	X	X	X	X	X	X	X	X	Special demolition of ex. pavement. Vertical mulch and decompact. SSAT excavation for base course of new pavement. Structural soil.	Mechanical Damage, Broken Limbs			
348	38	maple, red	Acer rubrum	50%	Fair	HERITAGE	19	57	X	X	X	X	X	X	X	X	X	X	Root-friendly curb design within CRZ. Excavation for pavement base course by arborist with SSAT.	Surface Roots, Root Damage/Decay, Co-Dominant Stems, Small DW (1-2"). Low Vigor, Broken Limbs, Branch Decay, Insect/Disease Problem, Fungal Fruiting Bodies DBH @ 2 ft. Possible soft rot fungus on large branch. Tar spot fungus. Mower damage/root decay on downhill side.			

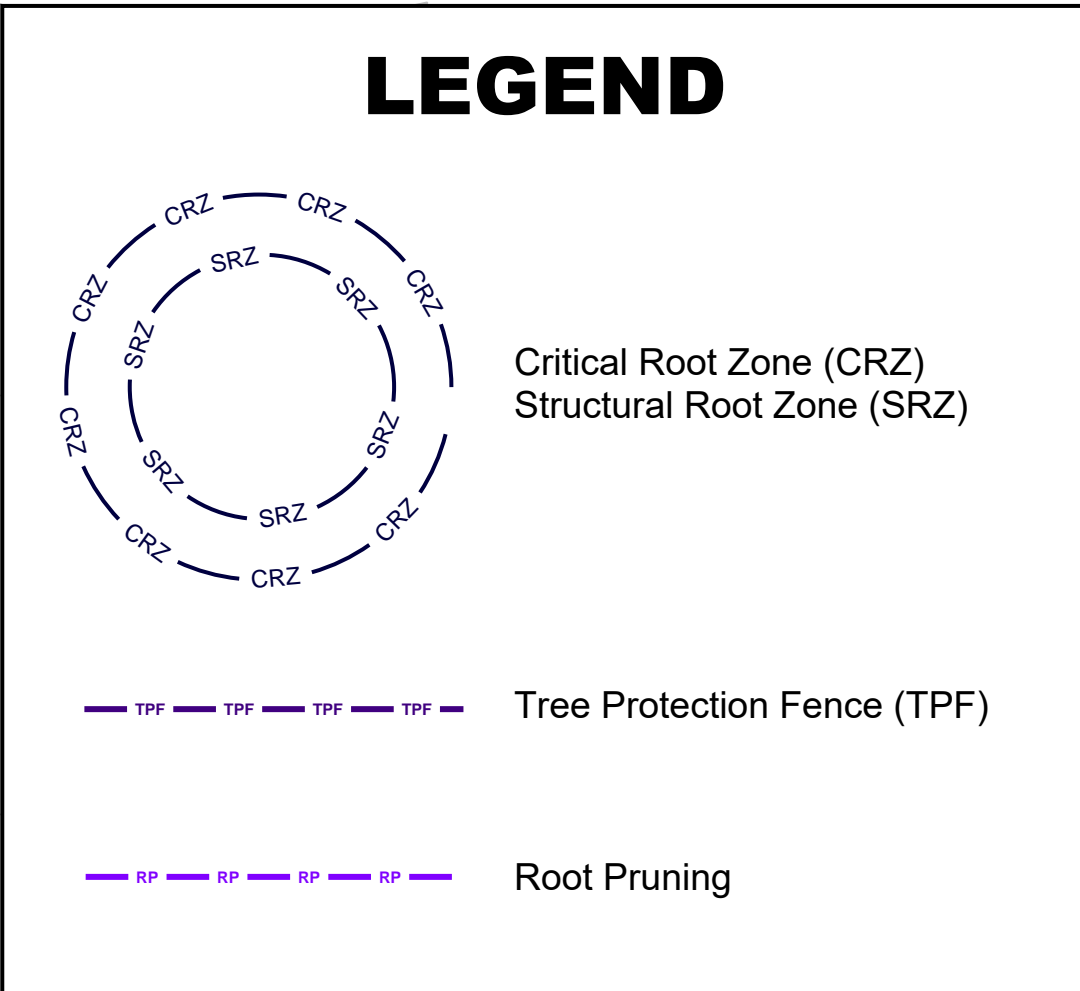

* Performed by or under supervision of ISA Certified Arborist.

**MARET SCHOOL
PROPOSED ATHLETIC FIELDS**
CORNER OF UTAH AVE NW &
NEBRASKA AVE NW
WASHINGTON, D.C. 20015

SITE UTILITY PLAN

WIKI CAPITOL REVISIONS	
E	DESCRIPTION

[illegible]

DATE: 08/23/21	
DES. KUO	DWN. BJR
SCALE: AS SHOWN	
PROJECT/FILE NO. VC0626C	
SHEET NO. CIV0300	

 "FOR LOCATION OF UTILITIES CALL
8-1-1 or 1-800-257-7777 OR LOG ON
or 48 HOURS IN ADVANCE OF ANY
WORK IN THIS VICINITY"

